

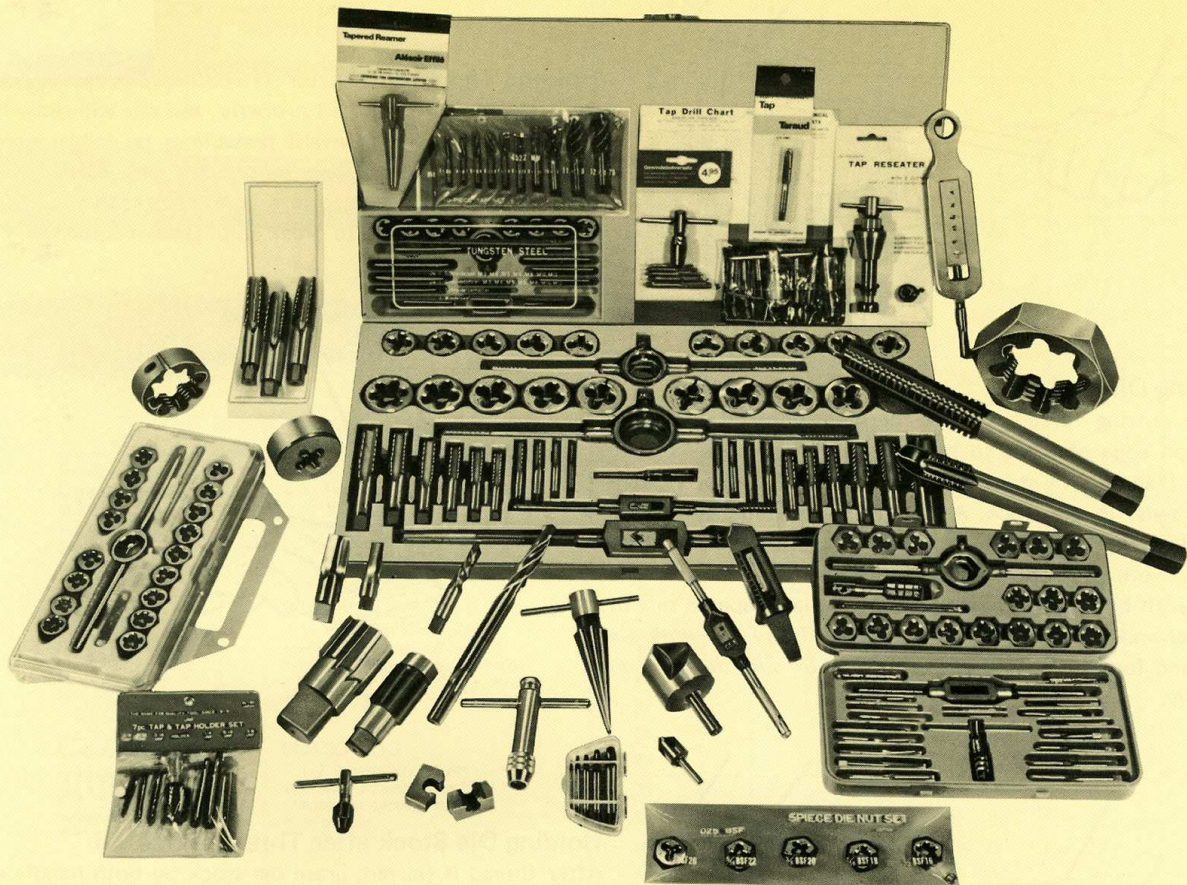

GUARANTEED QUALITY!!

TAPS DIES & ACCESSORIES

POPULAR TAP & DIE SET



HAND TAPS

HANDGEWINDEOHRER
MACHOS DE ROSCAR A MANO
TARAUDS

METRIC STANDARD

ART NO.801

Standard Hand Taps

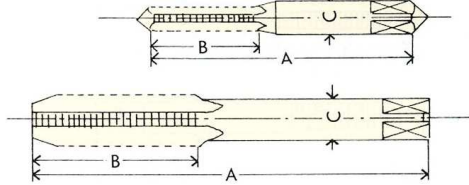

Spiral Pointed Taps NO.803PO

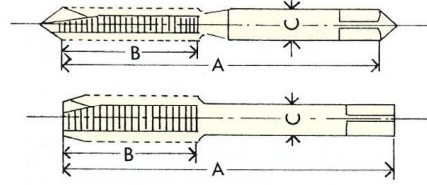

High Speed Steel
Tungsten Steel
ALLOY Steel

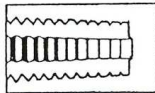
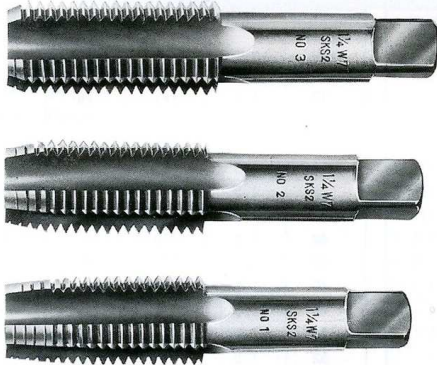

TAPER
8 to 10 threads chamfered for easy thread starting in rough materials.

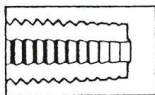

PLUG
3 to 5 threads chamfered—general use when tapping to bottom of holes is not critical. (This is the most widely-used type of tap.)

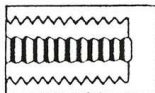

BOTTOMING
1, 1/2 threads chamfered—use after threads have been started for tapping to bottom of hole.

3 pc one set
METRIC 1.0mm up—to 12 mm in plastic case and 14mm and up in Printed box.

INCH1/16inch up—to 1/2inch in plastic case and 9/16inch and up in Printed box.

Nominal Diameter (mm)	Pitch (mm)	Length		Shank Dia C(mm)	Weight Per Set (g)
		A(mm)	B(mm)		
1	0.25	30	8	3	8
1.2	0.25	32	9	3	10
1.4	0.3	34	11	3	10
1.7	0.35	36	13	3	10
2	0.4	40	15	3	12
2.3	0.4	42	15	3	12
2.6	0.45	44	16	3	12
3	0.6	46	18	4	15
3	0.5	46	18	4	18
3.5	0.6	48	18	4	18
4	0.75	52	20	5	20
4	0.7	52	20	5	20
4.5	0.75	55	20	5	25
5	0.9	60	22	5.5	30
5	0.8	60	22	5.5	30
5.5	0.9	60	22	5.5	35
6	1	62	24	6	40
7	1	65	26	6.2	50
8	1.25	70	30	6.2	70
9	1.25	72	30	7	75
10	1.5	75	32	7	80
11	1.5	80	38	8	110
12	1.75	82	38	8.5	135
14	2	88	42	10.5	185
16	2	95	45	12.5	250
18	2.5	100	48	14	360
20	2.5	105	50	15	400
22	2.5	115	55	17	650
24	3	120	58	19	850
27	3	130	62	20	1180
30	3.5	135	65	23	1500
33	3.5	145	70	25	1980
36	4	155	75	28	2640
39	4	165	80	30	2920
42	4.5	175	85	32	3520
45	4.5	180	85	35	4090
48	5	185	90	38	5480
52	5	195	90	42	5900
56	5.5	205	95	44	8300
60	5.5	215	100	46	9750
64	6	225	105	48	11250
68	6	235	110	52	12980

INGREDIENT SPECIFICATION

Type of Steel	Elements	Chemical Composition										
		C % × 100	Si % × 100	Mn % × 100	P % × 1000	S % × 1000	Cu % × 100	Ni % × 100	Cr % × 100	Mo % × 100	W % × 100	V % × 100
SKH ₂		70~85	MAX 40	MAX 40	MAX 30	MAX 30			380~450		1700~1900	80~120
SKH ₉		80~90	MAX 40	MAX 40	MAX 30	MAX 30			380~450	450~550	550~670	160~220
SKS ₁₁		120~130	MAX 35	MAX 50	MAX 30	MAX 30			20~50		300~400	10~30
SKS ₂		100~110	MAX 35	MAX 80	MAX 30	MAX 30			50~100		100~150	
GSS ₂		97	MAX 18	MAX 97	MAX 24	MAX 17	9		48	21		
ALLOY		0.95~1.10	MAX 35	MAX 90	MAX 27	MAX 20			13~165			

HAND TAPS
 HANDGEWINDEOHRER
 MACHOS DE ROSCAR A MANO
 TARAUDS

**UNC. UNF. NS.
 BSW BSF**

ART NO.803

Standard Hand Taps

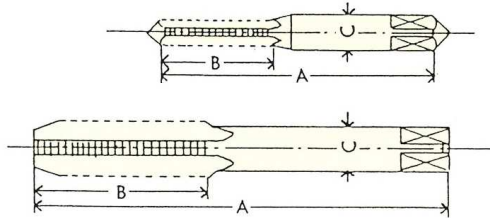

Spiral Pointed Taps

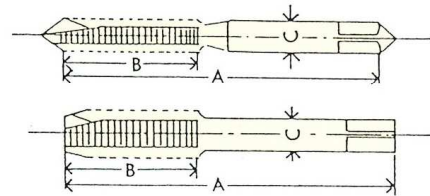

**High Speed Steel
 Tungsten Steel
 ALLOY Steel**

Nominal Diameter	Thread per inch					Length		Shank Dia C(mm)	Weight per set(g)
	(u)NC	(u)NF	(u)NS	BSW	BSF	A(mm)	B(mm)		
1/16	60		64.72	60		36	13	3	12
3/32	48		56	48		42	16	3	12
1/8	40	44	40.44	40	44	46	18	4	15
5/32	32	36	32.36	32	36	52	20	5	20
3/16	24	32	24.32	24	32	60	22	5.5	30
7/32	24	32	24.32	24		60	22	5.5	35
1/4	20	28	24.32	20	26	62	24	6	40
9/32	20		28.32	20		62	24	6	60
5/16	18	24	32	18	22	70	30	6.1	70
3/8	16	24	32	16	20	75	35	7	75
7/16	14	20	28	14	18	80	38	8	110
1/2	13	20	32.28	12	16	85	42	9	135
9/16	12	18	27	12	16	90	42	10.5	185
5/8	11	18	32	11	14	95	45	12	250
11/16	11	16	11.16	11	14	95	45	12	350
3/4	10	16	32	10	12	105	50	14	380
7/8	9	14	12.18	9	11	115	55	17	600
1	8	12	14.20	8	10	125	60	20	830
1 1/8	7	12	18	7	9	135	65	22	1270
1 1/4	7	12	18	7	9	145	70	24	1610
1 3/8	6	12	18	6	8	155	75	26	1980
1 1/2	6	12	18	6	8	160	78	30	2740
1 5/8	5	12	5 1/2	5	8	170	82	32	3560
1 3/4	5	12	6	5	7	175	85	35	4080
1 7/8	4 1/2	12	5	4 1/2	7	185	90	38	4690
2	4 1/2	12	4	4 1/2	7	195	92	40	6130
2 1/4	4 1/2	12	4 1/2	4	6	210	100	45	8500
2 1/2	4		4	4	6	225	105	48	11100
2 3/4	4		3 1/2	6	6	235	110	55	13500
3	4		3 1/2	5	5	250	115	58	14500
3 1/4	3 1/2		3 1/4			260	120	60	21500
3 1/2	3 1/4		3 1/4			270	124	62	25200
3 3/4	3		3			280	128	65	29000
4	3		3			295	132	72	33700
4 1/4			2 7/8			300	134	76	40700
4 1/2			2 7/8			310	136	80	46500
4 3/4			2 3/4			325	138	84	53000
5			2 3/4			335	140	88	63000
5 1/4			2 3/8			350	142	92	71500
5 1/2			2 5/8			360	144	95	79400
5 3/4			2 1/2			370	146	98	92500
6			2 1/2			380	150	100	104000
Angel of Thread	60°	60°	60°	55°	55°				

PIPE TAPS

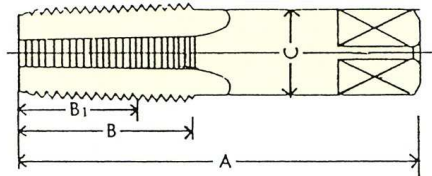
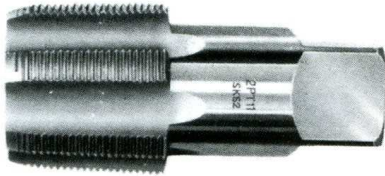

NPT
NPTF

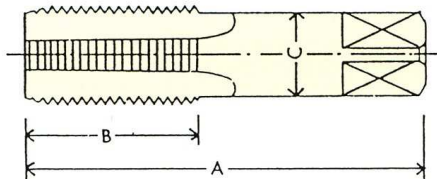

NPS
NPSF

ART NO. 804NT

NPT (AMERICAN NATIONAL TAPER PIPE THREAD)

ART NO. 804PF

NPTF (DRYSEAL AMERICAN NATIONAL TAPER PIPE THREAD)

ART NO. 805NS

NPS (AMERICAN NATIONAL STRAIGHT PIPE THREAD)

ART NO. 804SF

NPSF (DRYSEAL AMERICAN NATIONAL STRAIGHT PIPE THREAD)

High Speed Steel { Ground Thread
CUT Thread

Tungsten Steel

ALLOY Steel

Nominal Diameter	Thread	Basic Pitch	Regular				Weight Per Pc (g)
			A(mm)	B(mm)	Bl(mm)	C(mm)	
1/16	27	7.142	55	17.5	11.99	8	15
1/8	27	9.489	55	19	12.03	8	20
1/4	18	12.487	62	28	17.44	11	40
3/8	18	15.926	65	28	17.63	14	80
1/2	14	19.772	80	35	22.83	18	140
3/4	14	25.117	85	35	22.96	23	240
1	11 1/2	31.461	95	45	27.38	26	400
1 1/4	11 1/2	40.218	105	45	28.09	32	650
1 1/2	11 1/2	46.287	110	45	28.42	38	890
2	11 1/2	58.325	120	50	28.02	46	1350
2 1/2	8	70.159	145	65	40.82	55	2800
3	8	86.068	155	65	42.95	65	4200
3 1/2	8	98.776	165	68	44.68	70	6000
4	8	111.433	170	70	45.57	75	8600

ASA Standard				Number of Flutes
A(mm)	B(mm)	Bl(mm)	C(mm)	
54.0	17.5	11.99	7.938	4
54.0	19.1	12.03	11.113	4
61.9	27.0	17.44	14.288	4
65.1	27.0	17.63	17.780	4
79.4	34.9	22.83	17.463	4
82.6	34.9	22.96	23.020	5
95.3	44.5	27.38	28.575	5
101.6	44.5	28.09	33.338	5
108.0	44.5	28.42	38.100	7
114.3	44.5	28.02	47.625	7
139.7	65.1	40.82	57.150	8
152.4	66.7	42.95	66.675	8
165.1	68.3	44.68	71.438	9
171.4	69.8	45.57	76.200	9

ROUND DIES

RUNDE SCHNEIDEISEN
HILERAS DE ROSCAR REDONDAS
FILIERES

METRIC

ART NO.822

Round Adjustable Dies

Metric sizes

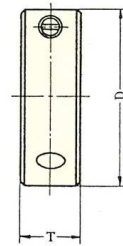
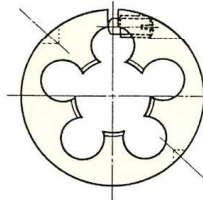
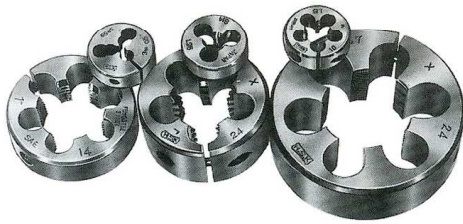

**High Speed Steel
Tungsten Steel
ALLOY Steel**

Nominal Diameter (mm)	Coarse Pitch (mm)	Fine-1 Pitch (mm)	Fine-2 Pitch (mm)	Fine-3 Pitch (mm)	Fine-4 Pitch (mm)	Outside Diameter and Thickness														
						13/16(20)	1(25)	1 1/16(33)	1 1/2(38)	2(50)	2 1/4(57)	2 1/2(63)	2 3/4(70)	3(75)	4(100)	5(127)				
						× 1/4	× 3/8	× 7/16	× 1/2	× 5/8	× 3/4	× 3/4	× 1	× 1	× 1 1/4	× 1 1/2				
1	0.25	0.2				13/16	1													
1.2	0.25	0.2				13/16	1													
1.4	0.3	0.2				13/16	1													
1.7	0.35	0.25	0.2			13/16	1													
2	0.4	0.25				13/16	1	1 5/16	1 1/2											
2.3	0.4	0.25				13/16	1	1 5/16	1 1/2											
2.6	0.45	0.35				13/16	1	1 5/16	1 1/2											
3	0.6	0.35				13/16	1	1 5/16	1 1/2											
3	0.5					13/16	1	1 5/16	1 1/2											
3.5	0.6	0.35				13/16	1	1 5/16	1 1/2											
4	0.75	0.5				13/16	1	1 5/16	1 1/2											
4	0.7					13/16	1	1 5/16	1 1/2											
4.5	0.75	0.5				13/16	1	1 5/16	1 1/2											
5	0.9	0.5				13/16	1	1 5/16	1 1/2											
5	0.8					13/16	1	1 5/16	1 1/2	2										
5.5	0.9	0.5				13/16	1	1 5/16	1 1/2	2										
6	1	0.75	0.5			13/16	1	1 5/16	1 1/2	2										
7	1	0.75	0.5			13/16	1	1 5/16	1 1/2	2										
8	1.25	1	0.75	0.5		13/16	1	1 5/16	1 1/2	2										
9	1.25	1	0.75	0.5		13/16	1	1 5/16	1 1/2	2										
10	1.5	1.25	1.0	0.75			1	1 5/16	1 1/2	2										
11	1.5	1.25	1.0	0.75			1	1 5/16	1 1/2	2										
12	1.75	1.5	1.25	1.0	0.5			1 5/16	1 1/2	2										
13	1.75	1.5	0.5					1 5/16	1 1/2	2										
14	2	1.5	1.25	1.0	0.5			1 5/16	1 1/2	2										
15	2	1.5	1.0	0.5				1 1/2	2	2	2 1/4	2 1/2								
16	2	1.5	1.0	0.5				1 1/2	2	2	2 1/4	2 1/2								
17	2	1.5	1.0	0.5				1 1/2	2	2	2 1/4	2 1/2								
18	2.5	2	1.5	1.0	0.5			1 1/2	2	2	2 1/4	2 1/2								
20	2.5	2	1.5	1.0	0.5				2	2	2 1/4	2 1/2								
22	2.5	2	1.5	1.0	0.5				2	2	2 1/4	2 1/2								
24	3	2	1.5	1.0	0.5				2	2	2 1/4	2 1/2								
25	3	2	1.5	1.0	0.5				2	2	2 1/4	2 1/2								
26	3	2	1.5	1.0	0.5				2	2	2 1/4	2 1/2					3			
27	3	2	1.5	1.0	0.5				2	2	2 1/4	2 1/2				2 3/4	3			
28	3	2	1.5	1.0	0.5				2	2	2 1/4	2 1/2				2 3/4	3			
30	3.5	2	1.5	1.0	0.5				2	2	2 1/4	2 1/2				2 3/4	3			
32	3.5	2	1.5	1.0	0.5						2 1/4	2 1/2				2 3/4	3			
33	3.5	2	1.5								2 1/4	2 1/2				2 3/4	3			
34	3.5	2	1.5	1.0	0.5						2 1/4	2 1/2				2 3/4	3			
36	4	2	1.5	1.0	0.5							2 1/2				2 3/4	3			
38	4	2	1.5	1.0	0.5							2 1/2				2 3/4	3			
39	4	2	1.5													2 3/4	3			
40	4	2	1.5	1.0												2 3/4	3			
42	4.5	3	1.5													2 3/4	3			
45	4.5	3	1.5														3	4		
48	5	3	1.5														3	4		
50	5	3	1.5														3	4	5	
52	5	3	1.5															4	5	
55	5	3	1.5															4	5	
56	5.5	3	1.5															4	5	
58	5.5		1.5															4	5	
60	5.5		1.5															4	5	
62	6.0		1.5																5	
64	6		1.5																5	
65	6		1.5																5	
68	6		1.5																5	
Angle of Thread			60°					12(g)	25(g)	80(g)	90(g)	180(g)	250(g)	330(g)	400(g)	600(g)	950(g)	1850(g)		

ROUND DIES

RUNDE SCHNEIDEISEN
HILERAS DE ROSCAR REDONDAS
FILIERES

ART NO.820

Gas Pipe Round Adjustable Dies BSPT BSPP NPT NPS

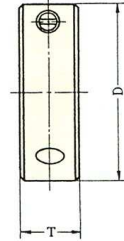
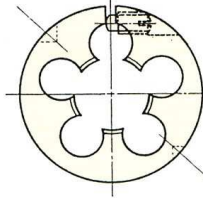

**High Speed Steel
Tungsten Steel
ALLOY Steel**

Cutting Size Per inch	Thread To in BSPT BSPP	Thread To in NPT NPS	Outside Diameter and Thickness											
			1 × 3/8	1 1/2 × 1/2	2 × 5/8	2 1/4 × 3/4	2 1/2 × 3/4	3 × 1	4 × 1 3/16	5 × 1 3/8				
1/16	28	27	1	1 1/2										
1/8	28	27	1	1 1/2										
1/4	19	18		1 1/2	2									
3/8	19	18		1 1/2	2									
1/2	14	14		1 1/2	2	2 1/4								
5/8	14	14			2	2 1/4								
3/4	14	14			2	2 1/4	2 1/2							
7/8	14	11 1/2				2 1/4	2 1/2	3						
1	11	11 1/2				2 1/4	2 1/2	3	4					
1 1/8	11	11 1/2					2 1/2	3	4					
1 1/4	11	11 1/2						3	4	5				
1 3/8	11	11 1/2						3	4	5				
1 1/2	11	11 1/2						3	4	5				
1 5/8	11	11 1/2						3	4	5				
1 3/4	11	11 1/2							4	5				
2	11	11 1/2								5				
2 1/4	11	11 1/2								5				
2 1/2	11	8								5				
2 3/4	11	8												
3	11	8												
3 1/4	11	8												
3 1/2	11	8												
3 3/4	11	8												
4	11	8												

British Standard Brass Dies

Size inch	Thread per inch	Outside Diameter inch			
1/4	26	1	1 1/2		
5/16	26	1	1 1/2		
3/8	26	1	1 1/2		
7/16	26	1	1 1/2		
1/2	26	1	1 1/2		2
9/16	26	1	1 1/2		2
5/8	26		1 1/2		2
3/4	26		1 1/2		2
7/8	26				2
1	26				2

British Standard Conduit Dies

Size inch	Thread per inch	Outside Diameter inch			
5/8	18	1 5/8	2 1/4		
3/4	16	1 5/8	2 1/4		
1	16	1 5/8	2 1/4		
1 1/4	16		2 1/4		
1 1/2	14				3 3/16
2	14				3 3/16

Metric Conduit Dies

Size mm	Pitch mm	Outside Diameter inch			
16	1.5	1 5/8	2 1/4		
20	1.5	1 5/8	2 1/4		
25	1.5	1 5/8	2 1/4		
32	1.5		2 1/4		
40	1.5		2 1/4		3 3/16
50	1.5		2 1/4		3 3/16

ROUND DIES

RUNDE SCHNEIDEISEN
HILERAS DE ROSCAR REDONDAS
FILIERES

ART NO.819

Round Adjustable Dies
Inch Sizes
NC NF NS BSW BSF

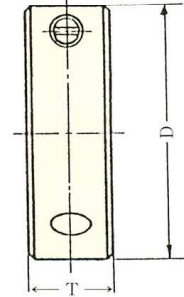
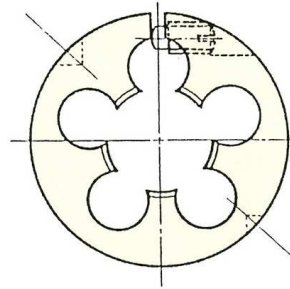
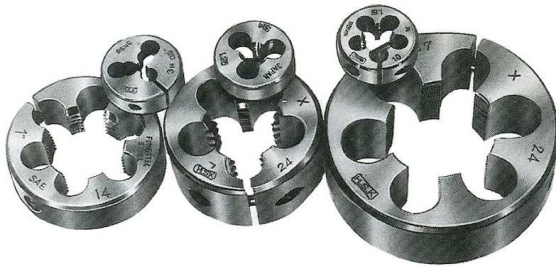

High Speed Steel
Tungsten Steel
ALLOY Steel

Nominal Diameter inch	Thread per inch					Outside Diameter and Thickness											
						$\frac{13}{16}(20)$	1" (25)	$1\frac{1}{16}(33)$	$1\frac{1}{2}(38)$	2" (50)	$2\frac{1}{4}(57)$	$2\frac{1}{2}(63)$	$2\frac{3}{4}(70)$	3" (75)	4" (100)		
	$\times \frac{1}{4}$	$\times \frac{3}{8}$	$\times \frac{7}{16}$	$\times \frac{1}{2}$	$\times \frac{5}{8}$	$\times \frac{3}{4}$	$\times \frac{3}{4}$	$\times 1$	$\times 1$	$\times 1\frac{1}{16}$							
$\frac{1}{16}$	60	64	64.72	60		$\frac{13}{16}$	1										
$\frac{3}{32}$	48	56	56	48		$\frac{13}{16}$	1										
$\frac{1}{8}$	40	44	40.44	40	44	$\frac{13}{16}$	1	$1\frac{1}{16}$	$1\frac{1}{2}$								
$\frac{5}{32}$	32	36	32.36	32	36	$\frac{13}{16}$	1	$1\frac{5}{16}$	$1\frac{1}{2}$								
$\frac{3}{16}$	24	32	24.32	24	32	$\frac{13}{16}$	1	$1\frac{9}{16}$	$1\frac{1}{2}$								
$\frac{7}{32}$	24	32	24.32	24		$\frac{13}{16}$	1	$1\frac{9}{16}$	$1\frac{1}{2}$								
$\frac{1}{4}$	20	28	24.32	20	26	$\frac{13}{16}$	1	$1\frac{5}{16}$	$1\frac{1}{2}$	2	$2\frac{1}{4}$						
$\frac{9}{32}$	20		28.32	20			1	$1\frac{5}{16}$	$1\frac{1}{2}$	2	$2\frac{1}{4}$						
$\frac{5}{16}$	18	24	32	18	22		1	$1\frac{5}{16}$	$1\frac{1}{2}$	2	$2\frac{1}{4}$						
$\frac{3}{8}$	16	24	32	16	20		1	$1\frac{5}{16}$	$1\frac{1}{2}$	2	$2\frac{1}{4}$						
$\frac{7}{16}$	14	20	28	14	18		1	$1\frac{5}{16}$	$1\frac{1}{2}$	2	$2\frac{1}{4}$						
$\frac{1}{2}$	13	20	28.32	12	16		1	$1\frac{5}{16}$	$1\frac{1}{2}$	2	$2\frac{1}{4}$	$2\frac{1}{2}$					
$\frac{9}{16}$	12	18	27	12	16				$1\frac{1}{2}$	2	$2\frac{1}{4}$	$2\frac{1}{2}$					
$\frac{5}{8}$	11	18	32	11	14				$1\frac{1}{2}$	2	$2\frac{1}{4}$	$2\frac{1}{2}$					
$\frac{11}{16}$	11	16	11.16	11	14				$1\frac{1}{2}$	2	$2\frac{1}{4}$	$2\frac{1}{2}$					
$\frac{3}{4}$	10	16	32	10	12				$1\frac{1}{2}$	2	$2\frac{1}{4}$	$2\frac{1}{2}$	$2\frac{3}{4}$				
$\frac{7}{8}$	9	14	12.18	9	11					2	$2\frac{1}{4}$	$2\frac{1}{2}$	$2\frac{3}{4}$	3			
1	8	12	14.20	8	10					2	$2\frac{1}{4}$	$2\frac{1}{2}$	$2\frac{3}{4}$	3			
$1\frac{1}{8}$	7	12	18	7	9						$2\frac{1}{4}$	$2\frac{1}{2}$	$2\frac{3}{4}$	3	4		
$1\frac{1}{4}$	7	12	18	7	9						$2\frac{1}{4}$	$2\frac{1}{2}$	$2\frac{3}{4}$	3	4		
$1\frac{3}{8}$	6	12	18	6	8							$2\frac{1}{2}$	$2\frac{3}{4}$	3	4		
$1\frac{1}{2}$	6	12	18	6	8							$2\frac{1}{2}$	$2\frac{3}{4}$	3	4		
$1\frac{5}{8}$	5			5	8								$2\frac{3}{4}$	3	4		
$1\frac{3}{4}$	5			5	7									3	4		
$1\frac{7}{8}$	$4\frac{1}{2}$			$4\frac{1}{2}$	7									3	4		
2	$4\frac{1}{2}$			$4\frac{1}{2}$	7									3	4		
$2\frac{1}{4}$	$4\frac{1}{2}$			4	6										4		
$2\frac{1}{2}$	4			4	6												
$2\frac{3}{4}$	4			$3\frac{1}{2}$	6												
3	4			$3\frac{1}{2}$	5												
Angle of Thread	60°	60°	60°	55°	55°	12(g)	25(g)	80(g)	90(g)	180(g)	320(g)	330(g)	400(g)	600(g)	950(g)		

ADJUSTABLE TAP and REAMER WRENCH

ART NO.823

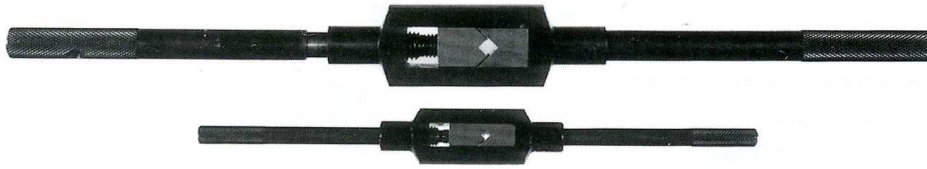

**DUCTILE BODY
STEEL HANDLE**

**DIE-CASTING BODY
STEEL HANDLE**

HIGH CLASS STANDARD CLASS

SKC NO.	CAPACITY (SIZE)		NOMINAL SIZE	LENGTH	NET WEIGHT
	HAND TAPS	PIPE TAPS			
0	1/16" TO 1/4"		1/4"	7"	100g
4	1/16 TO 3/8	1/8"	3/8	9	150
5	3/16 TO 1/2	1/8 TO 1/4"	1/2	11	250
6	1/4 TO 3/4	1/8 TO 3/8	3/4	15	500
7	3/8 TO 1	1/8 TO 3/4	1	19	1kg
7 1/2	5/8 TO 1 1/4	1/4 TO 1 1/8	1 1/4	31	3K600
8	3/4 TO 1 1/2	3/8 TO 1 1/4	1 1/2	40	5K650
10	7/8 TO 2	1 TO 2	2	45	5K980
22	1 TO 2 3/4	1 TO 2 1/2	2 3/4	50	6K540
24	1 3/4 TO 4	2 TO 3 1/2	4	75	11K250

NEW EXCELLENT	NEW EXCELLENT	NEW EXCELLENT
DIE STOCK	TAP WRENCH	5 PC.Screw Extractor Set
Porte-File' res	Tourne-a gaicje	Jeu de 5 Extracteurs de Vis
Schneideisenhalter	Verstellbare Windeisen	5-teilig, Schraubenausdrehersatz

S/NO.ET-39DS:ROUND DIE
S/NO.ET-39HEX:HEXAGON DIE
ADJUSTABLE GUIDE
1"O/D
1A/F

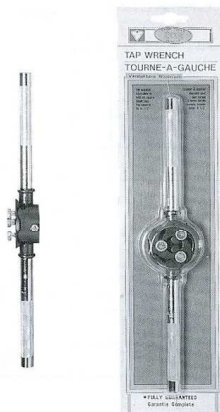

CAPACITY INCH	CAPACITY M/M	N. W
1"	25 φ	250g

S/NO.ET-39TW

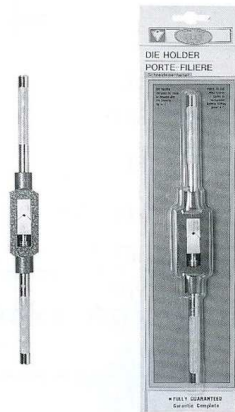

CAPACITY INCH	CAPACITY M/M	N. W.
1/8" ~ 1/2"	M3~M12	250g

S/NO.ET-5V
PLASTIC CASE

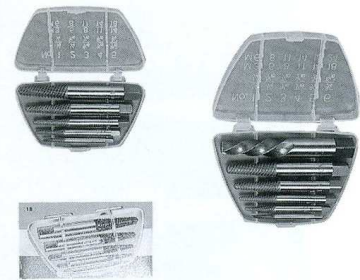

- CHROME VANADIUM STEEL
- SPIRAL FINE FLUTE

INCLUDING:

- #1FOR 3/16 TO 1/4 SCREW
- #2FOR 1/4 TO 5/16 SCREW
- #3FOR 5/16 TO 7/16 SCREW
- #4FOR 7/16 TO 9/16 SCREW
- #5FOR 9/16 TO 3/4 SCREW

PER CASE	G. W.	MEAS' T
20 doz.	24kg	1.1 CFT

TAP HOLDER

ART NO.868

■ RATCHET TYPE

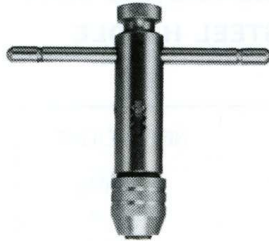

WITH 2 JAWS OF HARDENED AND TEMPERED STEEL
ALL CHROME PLATED FINISH OR BLACK FINISH
FOR "HEAVY DUTY OPERATION"

■ SPRING TYPE



SKC NO.	CAPACITY (SIZE) HAND TAPS	(SIZE)NO. DIA OF INCH	CAPACITY SIZE M/M TAPS	WEIGHT
R1	1/8" TO 3/8"	3/8"	M3 TO M10	220g
R2	7/32 TO 1/2	1/2	5 TO 12	300

SKC NO.	CAPACITY SIZE HAND TAPS	SIZE DIA. OF INCH	CAPACITY SIZE M/M TAPS	WEIGHT
S1	1/16" TO 3/16"	3/16"	MITOM 5	80g
S2	5/32 TO 1/4	1/4	3TO 6	110
S3	3/16 TO 3/8	3/8	5TO 10	200
S4	1/4 TO 1/2	1/2	6TO 12	320

3PC. TAP HOLDER SET

VINYL KIT OR BLISTER PACK

ART NO.703

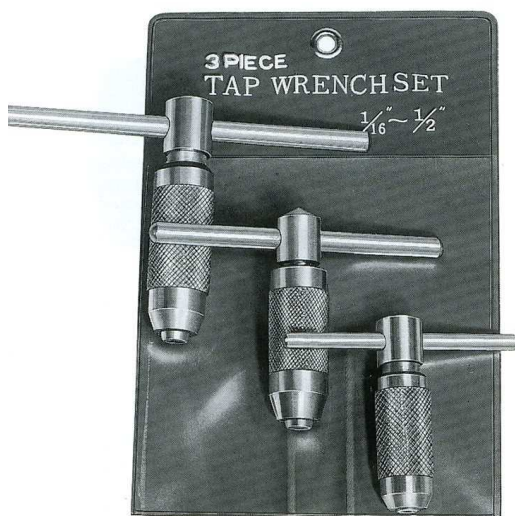

	NO.	CAPACITY (TAPS)	NET WEIGHT
"T" TYPE 3PCS. SET	T - 10	1/16" ~ 3/16"	30g
	T - 20	5/32 ~ 1/4	40
	T - 30	3/16 ~ 3/8	65
"T" TYPE	T - 40	1/4 ~ 1/2	150
G. P. TYPE 3PCS. SET	GP-100	1/16 ~ 3/16	70
	GP-200	5/32 ~ 1/4	80
	GP-300	3/16 ~ 3/8	90
G. P. TYPE	GP-400	1/4 ~ 1/2	200
PER CASE	G. W.	MEAS' T	
10 DOZ	30kg	1.1 CFT	CARTON

**STOCK FOR ROUND DIES
STOCK FOR HEX DIES**

ART NO.824

Stock for Round Dies

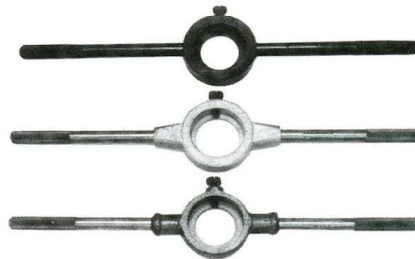
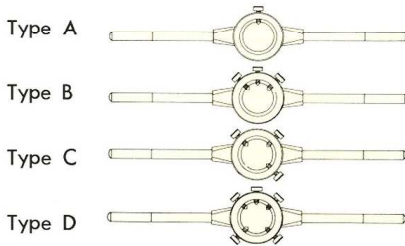

- STEEL
- DIE-CASTING BODY
STEEL HANDLE
- CAST-IRON BODY
STEEL HANDLE

SKC NO.	Outside Diameter of Round Dies	Length			Net. Wt
		STEEL	DIE-CASTING BODY STEEL HANDLE	CAST-IRON BODY STEEL HANDLE	
S-1950	$\frac{5}{8}$ (15.8mm)	$\frac{7}{32}$ (185mm)	DIE CASTING HANDLE $\frac{7^{15}}{32}$ (190mm) $\text{D}8^{29}/64$ (255) $\text{S}7^{21}/64$ (187)		100(g)
S-1951	$\frac{13}{16}$ (20 mm)	$\frac{7}{32}$ (185mm)			100(g)
S-1952	1 (25 mm)	$\frac{7}{32}$ (185mm)			100(g)
S-1955	1 $\frac{1}{2}$ (38 mm)	12 $\frac{13}{64}$ (310mm)	12 (305mm)	12 (305mm)	370(g)
S-1958	2 (50 mm)	15 $\frac{3}{4}$ (400mm)	14 $\frac{9}{16}$ (375mm)	15 $\frac{23}{64}$ (390mm)	700(g)
S-1959	2 $\frac{1}{4}$ (57 mm)			18 $\frac{1}{2}$ (470mm)	1200(g)
S-1960	2 $\frac{1}{2}$ (63 mm)			21 $\frac{1}{16}$ (535mm)	1400(g)
S-1961	2 $\frac{3}{4}$ (70 mm)			21 $\frac{29}{64}$ (545mm)	1600(g)
S-1962	3 (75 mm)			21 $\frac{27}{32}$ (555mm)	1800(g)
S-1963	4 (100 mm)			35 $\frac{27}{64}$ (900mm)	4000(g)
S-1964	5 (127 mm)			49 $\frac{7}{32}$ (1250mm)	7500(g)
S-1965	1 $\frac{5}{8}$ (42 mm)			16 (400mm)	600(g)
S-1954	1 $\frac{5}{16}$ (33 mm)			12 (305mm)	210(g)

Stock for Hex Dies

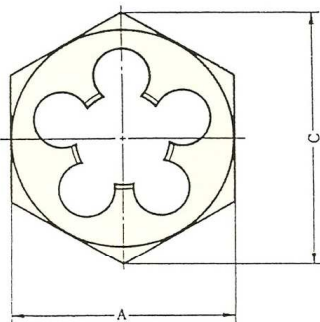

DIE-CASTING BODY
STEEL HANDLE

(Across Flats)

SKC NO.	Across Hex Flats A	Length		Net. Wt.
		DIE-CASTING BODY STEEL HANDLE		
S-1977	1	8 $\frac{1}{4}$ (210mm)		150g
S-1978	1 $\frac{7}{16}$	12 (305mm)		295
S-1979	1 $\frac{13}{16}$	14 $\frac{9}{16}$ (375mm)		590

Die Stocks Adjustable Guide



DIE-CASTING BODY
STEEL HANDLE

	SKC NO.	Length	Net. Wt.
Outside Diameter of Round Dies 1inch	S-1980	250mm	220(g)
Across Hex Flats A 1inch	S-1981	250mm	220(g)

5 PC. SCREW EXTRACTOR SET

ONE SET IN A VINYL KIT OR PLASTIC CASE

ART NO.705



45 CARBON STEEL 5 pieces a set
HIGH CARBON STEEL
CHROME VANADIUM STEEL
SPIRAL FINE FLUTE
SPIRAL COARSE FLUTE
STRAIGHT FLUTE (SQUARE TYPE)

INCLUDING	#1 FOR	3/16	TO	1/4	SCREW
	#2 FOR	1/4	TO	5/16	SCREW
	#3 FOR	5/16	TO	7/16	SCREW
	#4 FOR	7/16	TO	9/16	SCREW
	#5 FOR	9/16	TO	3/4	SCREW

PER CASE	G. W.	MEAS' T	
20 doz	20kg	1.1CFT	CARTON

SCREW EXTRACTOR and SET

ART NO.843



SPiral FINE FLUTE
SPiral COARSE FLUTE
STRAIGHT FLUTE (SQUARE TYPE)

Useful for extraction the remained screw easily without giving any damage to the screw threads when bolt or screw happens to break inside the screw hole and it is applied for detaching small coupling of iron pipe and extraction broken pipe in the screw hole of valve etc,

NO. OF COMBI-NATION SET	NO. OF CONTENTS	NOS	WEIGHT	REMARK
1815	801.2.3.4.5	5 Ea	200g	
1816	801.2.3.4.5.6	6	370	
1817	804.5.6	3	320	With H. S. S. Drill
1818	806.7.8.9	4	1,800	
1820	801.2.3.4.5.6	6	820	
1821	805.5 1/4.6 3/8.7 1/2.	4	966	
1822	805.5 1/4.6 3/8.7 1/2.8.9	6	2,400	earth 2 pcs
1829	801.2.3.4.5.6	12	750	With Stand
1830	801.2.3.4.5.5 1/4.6	7	440	Case

NO.1830—SKC With Special Standard (With details into earth packing)

EXTRACTOR NUMBER	DIMENSIONS—INCHES				SIZE DRILL TO USE Inches	FOR SCREWS AND BOLTS, SIZES Inches	FOR PIPE SIZES Inches	WEIGHT
	Diameter Small End	Diameter Large End	Length of Thread	Length Overall				
1	1/16	1/8	1/2	2	5/64	3/16 — 1/4		5g
2	3/32	13/64	7/8	2 3/8	7/64	1/4 — 5/16		10
3	1/8	1/4	1	2 11/16	5/32	5/16 — 7/16		18
4	3/16	11/32	1 1/4	3	1/4	7/16 — 9/16		30
5	1/4	7/16	1 1/2	3 3/8	17/64	9/16 — 3/4	1/8	45
5 1/4	11/32	17/32	1 1/2	3 3/8	23/64	11/16 — 15/16	1/4	80
6	3/8	19/32	1 3/4	3 3/4	13/32	3/4 — 1	105	105
6 3/8	15/32	11/16	1 11/16	3 3/4	31/64	15/16 — 1 1/8	3/8	150
7	1/2	25/32	2 1/4	4 1/8	17/32	1 — 1 3/8		190
7 1/2	19/32	7/8	2 1/4	4 1/8	39/64	1 1/8 — 1 1/2	1/2	220
8	3/4	1 1/32	2 1/4	4 3/8	13/16	1 3/8 — 1 3/4	3/4	370
9	1	1 9/32	2 1/4	4 5/8	1 1/16	1 3/4 — 2 1/8	1	580
10	1 1/4	1 9/16	2 1/2	5	1 5/16	2 1/8 — 2 1/2	1 1/4	1000
11	1 1/2	1 7/8	3	5 5/8	1 9/16	2 1/2 — 3	1 1/2	1500
12	1 27/32	2 9/32	3 1/2	6 1/4	1 15/16	3 — 3 1/2	2	2600

PIPE THREAD (GAS) TAP AND DIE SET

ART NO.831

ALL STRONG METAL CASE

• CONTENTS:

SET NO.	R-1	R-2	R-3	R-4
CUTTING SIZE PER GAS THREAD ONE PIPE TAP & ONE ROUND DIE EACH PC.	1/8-28 1/4-19 3/8-19 1/2-14	1/8-28 1/4-19 3/8-19 1/2-14 5/8-14 3/4-14	1/8-28 1/4-19 3/8-19 1/2-14 5/8-14 3/4-14 7/8-14 1 -11	1/8-28 1/4-19 3/8-19 1/2-14 5/8-14 3/4-14 7/8-14 1 -11 1 1/8-11 1 1/4-11
DIES DIAM	2"	2"	2" 2 1/2"	2 1/2" 3"
STOCK LENGTH	20"	20"	20" 26"	20 30" 26
TAP WRENCH NO.	6	7	6 7 1/2	6 9
NET WEIGHT PER CASE	4kg	7.0kg	9.5kg	12.5kg
	5	5	2	2

- METAL CASE BOX
- ABS PRASTIC TRAY

**ALLOY STEEL
HIGH SPEED STEEL**

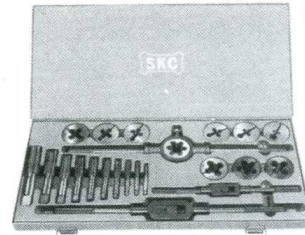

SOLID SQUARE DIES

ART NO.836

BOLT AND GAS PIPE THREAD

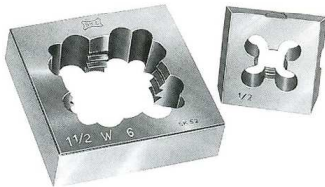

**ALLOY STEEL
HIGH SPEED STEEL**

Nominal Diameter inch	Thread per inch						Square inches and Thickness			
	Pipe Thread		(u)NC	(u)NF	(u)NS	BSW	2×2 (1/2Or3/4)	2 1/2×2 1/2 (3/4)	3×3 (1)	4×4 (1)
	NPT	BSPT								
1/4	18	19	20	28	24.32	20	2×2	2 1/2×2 1/2		
9/32			20		20	2×2	2 1/2×2 1/2			
5/16			18	24	32	18	2×2	2 1/2×2 1/2		
3/8			16	24	32	16	2×2	2 1/2×2 1/2		
7/16			14	20	28	14	2×2	2 1/2×2 1/2		
1/2	14	14	13	20	32.28	12	2×2	2 1/2×2 1/2	3×3	
9/16			12	18	32	12	2×2	2 1/2×2 1/2	3×3	
5/8			11	18	32	11	2×2	2 1/2×2 1/2	3×3	
11/16			11	16	11.16	11	2×2	2 1/2×2 1/2	3×3	
3/4			10	16	32	10	2×2	2 1/2×2 1/2	3×3	
7/8	11 1/2	11	9	14		9	2×2	2 1/2×2 1/2	3×3	
1			8	12	14.20	8	2×2	2 1/2×2 1/2	3×3	4×4
1 1/8			7	12		7		2 1/2×2 1/2	3×3	4×4
1 1/4			7	12		7		2 1/2×2 1/2	3×3	4×4
1 3/8			6	12		6			3×3	4×4
1 1/2	11 1/2	11	6	12		6			3×3	4×4
1 5/8			5			5				4×4
1 3/4			5			5				4×4
1 7/8			4 1/2			4 1/2				4×4
2			4 1/2			4 1/2				4×4

SOLID SQUARE DIES

ART NO.836

BOLT AND GAS PIPE THREAD

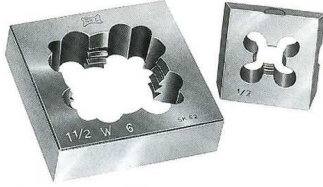

**ALLOY STEEL
HIGH SPEED STEEL**

Nominal Diameter inch	Thread per inch						Square inches and Thickness			
	Pipe Thread		(u)NC	(u)NF	(u)NS	BSW	2×2 (1/2 or 3/4)	2 1/2×2 1/2 (3/4)	3×3 (1)	4×4 (1)
	NPT	BSPT								
1/4	18	19	20	28	24.32	20	2×2	2 1/2×2 1/2		
9/32			20			20	2×2	2 1/2×2 1/2		
5/16			18	24	32	18	2×2	2 1/2×2 1/2		
3/8			16	24	32	16	2×2	2 1/2×2 1/2		
7/16			14	20	28	14	2×2	2 1/2×2 1/2		
1/2	14	14	13	20	32.28	12	2×2	2 1/2×2 1/2	3×3	
9/16			12	18	12	2×2	2 1/2×2 1/2	3×3		
5/8			11	18	32	11	2×2	2 1/2×2 1/2	3×3	
11/16			11	16	11.16	11	2×2	2 1/2×2 1/2	3×3	
3/4			10	16	32	10	2×2	2 1/2×2 1/2	3×3	
7/8	11 1/2	14	9	14		9	2×2	2 1/2×2 1/2	3×3	
1	11 1/2	11	8	12	14.20	8	2×2	2 1/2×2 1/2	3×3	4×4
1 1/8	11 1/2	11	7	12		7		2 1/2×2 1/2	3×3	4×4
1 1/4	11 1/2	11	7	12		7		2 1/2×2 1/2	3×3	4×4
1 3/8	11 1/2	11	6	12		6		2 1/2×2 1/2	3×3	4×4
1 1/2	11 1/2	11	6	12		6			3×3	4×4
1 5/8	11 1/2	11	5			5				4×4
1 3/4	11 1/2	11	5			5				4×4
1 7/8	11 1/2	11	4 1/2			4 1/2				4×4
2	11 1/2	11	4 1/2			4 1/2				4×4

PIPE THREAD (GAS) TAP AND DIE SET

ART NO.831

ALL STRONG METAL CASE

• CONTENTS:

SET NO.	R-1	R-2	R-3	R-4
CUTTING SIZE PER GAS THREAD ONE PIPE TAP & ONE ROUND DIE EACH PC.	1/8-28 1/4-19 3/8-19 1/2-14	1/8-28 1/4-19 3/8-19 1/2-14 5/8-14 3/4-14	1/8-28 1/4-19 3/8-19 1/2-14 5/8-14 3/4-14 7/8-14 1-11	1/8-28 1/4-19 3/8-19 1/2-14 5/8-14 3/4-14 7/8-14 1-11 1 1/8-11 1 1/4-11
DIES DIAM	2"	2"	2" 2 1/2"	2 1/2" 3"
STOCK LENGTH	20"	20"	20" 26"	20 30" 26
TAP WRENCH NO.	6	7	6 7 1/2	6 9
NET WEIGHT	4kg	7.0kg	9.5kg	12.5kg
PER CASE	5	5	2	2

- METAL CASE BOX
- ABS PRASTIC TRAY

**ALLOY STEEL
HIGH SPEED STEEL**

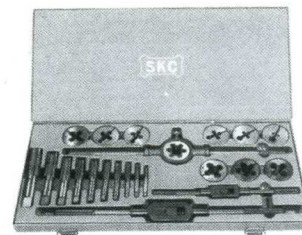

HIGH QUALITY TUNGSTEN STEEL PROFESSIONAL QUALITY

ART NO.850R

40 PC. TAP and DIE SET

- ADJUSTABLE ROUND SPILT DIE TYPE
- SOLID ROUND DIE TYPE
- ALL POLISH



HOW TAP SIZES ARE DESIGNATED

The first number or fraction, represents the diameter of the screw or bolt. The second, the number of threads per inch. (this is the number of revolutions the screw travels in one inch). The letters indicate the thread series in one of these five types:

- NC(USS)—National Coarse
- NF(SAE)—National Fine
- NS—National Special
- NPT—National Pipe Taper
- NPS—National Pipe Straight
- ISO—International Metric
- SI—International Metric
- SF—French Metric
- DIN—German Metric

PLASTIC HANDY STORAGE BOX

- 17 Round Dies
- 17 Plug Taps
- Die Stock (1 inch O.D.)
- 1 "T" Type Tap Wrench^{1/8}-^{1/4} (3 M/M-12M/M)
- 1 "T" Type Tap Wrench^{1/4}-^{1/2} (6 M/M-12M/M)
- Adjustable Tap Wrench (^{1/8}-^{1/2})
- 1 Screw Pitch Gauge
- 1 Screw Driver

Contents Per Carton	G.W.	CFT
10 SETS	20kg	0.8

RD-CF	RD-WF	RD-MM	RD-WM	RD-DIN
NC & NF	BSW & SAE	METRIC & BSP	BSW & METRIC	METRIC(DIN)
4NC40 ^{1/2} NC13	^{1/8} W40 ^{1/8} NF44	3M0.6 3M0.5	^{1/8} W40 3M0.5	3×0.5 3×0.6
6NC32 10NF32	^{5/32} W32 ^{5/32} NF36	4M0.75 4M0.7	^{1/4} W20 4M0.7	4×0.7 4×0.75
8NC32 ^{1/4} NF28	^{3/16} W24 ^{3/16} NF32	5M0.9 5M0.8	^{5/16} W18 5M0.8	5×0.8 5×0.9
10NC24 ^{5/16} NF24	^{1/4} W20 ^{1/4} NF28	6M1.0 6M0.75	^{3/8} W16 6M1.0	6×1.0 8×1.0
12NC24 ^{3/8} NF24	^{5/16} W18 ^{5/16} NF24	7M1.0 7M0.75	^{7/16} W14 7M1.0	7×1.0 10×1.25
^{1/4} NC20 ^{7/16} NF20	^{3/8} W16 ^{3/8} NF24	8M1.25 8M1.0	^{1/2} W12 8M1.25	8×1.25 11×1.50
^{5/16} NC18 ^{1/2} NF20	^{7/16} W14 ^{7/16} NF20	10M1.5 10M1.25	^{5/8} BSP 9M1.25	9×1.25 12×1.5
^{3/8} NC16 ^{1/2} NPT	^{1/2} W12 ^{1/2} NF20	12M1.75 12M1.5	10M1.5	10×1.50 12×1.25
^{7/16} NC14	^{1/8} BSP	^{1/8} BSP	11M1.5	12×1.75
			12M1.75	

PLASTIC COLOUR GREEN RED ORANGE

HIGH QUALITY TUNGSTEN STEEL PROFESSIONAL QUALITY

ART NO.850H

40 PC. TAP and HEX DIE SET

ALL POLISH



HOW TAP SIZES ARE DESIGNATED

The first number, or fraction, represents the diameter of the screw or bolt. The second, the number of threads per inch (this is the number of revolutions the screw travels in one inch.) The letters indicate the thread series in one of these five types:

- NC(USS)—National Coarse
- NF(SAE)—National Fine
- NS—National Special
- NPT—National Pipe Taper
- NPS—National Pipe Straight
- ISO—International Metric
- SI—International Metric
- SF—French Metric
- DIN—German Metric

PLASTIC HANDY STORAGE BOX

- 17 Hex Dies
- 17 Plug Taps
- 1 "T" Type Tap Wrench^{1/8}-^{1/4} (3M/M-6M/M)
- 1 "T" Type Tap Wrench^{1/4}-^{1/2} (3M/M-6M/M)
- 1 Screw Pitch Gauge
- 1 Screw Driver

Contents Per Carton	G.W.	CFT
10SETS	25kg.	0.8

HD-CF	HD-WF	HD-DIN	HD-WM	HD-MM
NC & NF	BSW & SAE	METRIC & BSP	BSW & METRIC	METRIC
4NC40 ^{1/2} NC13	^{1/8} W40 ^{1/8} NF44	3M0.6 3M0.5	^{1/8} W40 M3M0.5	M3×0.6
6NC32 10NF32	^{5/32} W32 ^{5/32} NF36	4M0.75 4M0.7	^{1/4} W20 4M0.7	4×0.7 4×0.75
8NC32 ^{1/4} NF28	^{3/16} W24 ^{3/16} NF32	5M0.9 5M0.8	^{5/16} W18 5M0.8	5×0.8 5×0.9
10NC24 ^{5/16} NF24	^{1/4} W20 ^{1/4} NF28	6M1.0 6M0.75	^{3/8} W16 6M1.0	6×1.0 8×1.0
12NC24 ^{3/8} NF24	^{5/16} W18 ^{5/16} NF24	7M1.0 7M0.75	^{7/16} W14 7M1.0	7×1.0 10×1.25
^{1/4} NC20 ^{7/16} NF20	^{3/8} W16 ^{3/8} NF24	8M1.25 8M1.0	^{1/2} W12 8M1.25	8×1.25 11×1.50
^{5/16} NC18 ^{1/2} NF20	^{7/16} W14 ^{7/16} NF20	10M1.5 10M1.25	^{5/8} BSP 9M1.25	9×1.25 12×1.25
^{3/8} NC16 ^{1/2} NPT	^{1/2} W12 ^{1/2} NF20	12M1.75 12M1.5	10M1.5	10×1.50 12×1.25
^{7/16} NC14	^{1/8} BSP	^{1/8} BSP	11M1.5	12×1.75
			12M1.75	

PLASTIC COLOUR GREEN RED ORANGE

EXCELLENT 60 PC. TAP and DIE SET

ART NO.860

JEU DE 60 FILIERES ET DE TARAUDS
60-TEILIG GEWINDESCHNEIDWERKZEUGSATZ

- SET NO.ET-60RD:SOLID ROUND DIES
- SET NO.ET-60ARD:ADJUSTABLE ROUND DIES
- SET NO.ET-60HEX:HEXAGON DIES

**HIGH SPEED STEEL
ALLOY TOOL STEEL**



COMPLETE THREADING SET

CONTAINS ONE EACH PLUG TAP AND 1" O/D(A/F) DIE FOR THE FOLLOWING 27 THREAD SIZES AND RELATED ACCESSORIES INDICATED.

PACKED IN AN ATTRACTIVE METAL CASE.

# 4-40	#12-24	3/8-16	5/16-24	1/8NPT27	M5×0.8	M 9×1.25
# 6-32	#10-32	7/16-14	3/8-24	(PIPE)	M6×1.0	M10×1.5
# 8-32	1/4-20	1/2-13	7/16-20	M3×0.5	M7×1.0	M10×1.0
#10-24	5/16-18	1/4-28	1/2-20	M4×0.7	M8×1.25	M12×1.75

RELATED ACCESSORIES:

- 1 DIE STOCK ADJUSTABLE GIDE (1" O/D OR 1" A/F)
- 1 ADJUSTABLE TAP WRENCH 1/8-1/2 (M3-M12)
- 1 "T" TYPE TAP WRENCH 1/8-1/4 (M3-M6)
- 1 SCREW DRIVER
- 2 SCREW PITCH GAUGES (METRIC & SAE)

CONTENTS PER CARTON	N. W.	G. W.	CFT
10 SETS	30kgs	31kgs	1.6

Contains the most popular sizes in:
SAE INCH ... NATIONAL COARSE and NATIONAL FINE THREAD and METRIC
USED FOR THE FOLLOWING CARS:
AMERICAN · JAPANESE · EUROPEAN CARS & MOTORCYCLES...
General Motors · Chrysler · Ford · American Motors · Datsun · Toyota · Volkswagen · Mercedes · Renault · Fiat.

HIGH QUALITY TUNGSTEN STEEL PROFESSIONAL QUALITY

16 PC. TAP and DIE SET

ART NO.716

**TRANSPARENT
PLASTIC LID
ON TOOLS**

PLASTIC CASE
PLASTIC COLOUR
ORANGE BLUE



**METAL CASE
"ABS" PLASTIC
TRAY**

METAL CASE
METAL CASE
COLOUR
BLUE RED



FOR AUTO & REPAIR SHOPS FOR INDUSTRIAL USE

- ADJUSTABLE ROUND SPLIT DIE TYPE
- SOLID ROUND DIE TYPE

ALLOY STEEL

HIGH SPEED STEEL

SKC NO.	16W	16WW	16NC	16NF	16NF	16NF
THREAD	BSW	BSW	UNC	UNF(SAE)	UNF(SAE)	UNF(SAE)
CUTTING SIZE	1/16" × 60	1/8" × 40	6 × 32	1/8" × 44	M3 × 0.6	M3 × 0.5
ONE PLUG TAP & ROUND DIE	3/32 × 48	3/16 × 24	8 × 32	3/16 × 32	3.5 × 0.6	4 × 0.7
	1/8 × 40	1/4 × 20	10 × 24	1/4 × 28	4 × 0.75	5 × 0.8
	5/32 × 32	5/16 × 18	1/4" × 20	5/16 × 24	4.5 × 0.75	6 × 1.0
	3/16 × 24	3/8 × 16	5/16 × 18	3/8 × 24	5 × 0.9	8 × 1.25
	7/32 × 24	7/16 × 14	3/8 × 16	7/16 × 20	6 × 1.0	10 × 1.5
	1/4 × 20	1/2 × 12	1/2 × 13	1/2 × 20	8 × 1.25	12 × 1.75
DIE STOCK	1"	1"	1"	1"	1"	1"
TAP WRENCH	1/16-1/4	1/8-1/2	1/8-1/2	1/8-1/2	1/8-1/2	1/8-1/2
WEIGHT	800g	900g	900g	900g	900g	900g
CONTENTS PER CARTON			G. W.		CFT	
24 SETS			23kg		1.0	